

## NOTICE OF MEETING

MEETING	<b>LICENSING ACT 2003 SUB-COMMITTEE</b>
DATE:	<b>WEDNESDAY 7 JULY 2010</b>
TIME:	<b>9.30 am</b>
VENUE:	<b>COUNCIL CHAMBER - TOWN HALL</b>
CONTACT:	<i>Gemma George, Senior Governance Officer</i> <i>Telephone: 01733 452268</i> <i>e-mail address: gemma.george@peterborough.gov.uk</i>
<i>Despatch date:</i>	<i>29 June 2010</i>

### AGENDA

### PAGE NO

1. **Apologies**
2. **Declarations of Interest**
3. **Application for Variation of Premises Licence - Select and Save, 9-11 Scalford Drive, Peterborough, PE1 4XQ** 1 - 56



There is an induction hearing loop system available in all meeting rooms. Some of the systems are infra-red operated, if you wish to use this system then please contact Gemma George on 01733 452268.

This page is intentionally left blank

<b>LICENSING ACT 2003 SUB-COMMITTEE</b>		<b>AGENDA ITEM No. 3</b>
<b>7 JULY 2010</b>		<b>PUBLIC REPORT</b>
Contact Officers:	Adrian Day, Licensing Manager, Terri Martin, Licensing Regulatory Officer	Tel: 454437 Tel. 453561

**APPLICATION: VARIATION OF PREMISES LICENCE**

**LICENCE REFERENCE:** MAU 059342

**APPLICANT:** Mr Naser Yousaf

**PREMISES:** Select and Save, 9-11 Scalford Drive, Peterborough, PE1 4XQ

**REPRESENTED BY:** Mr Vikram Singh, H & V Solicitors, 583 Lincoln Road, Peterborough, PE1 2PB

**GLOSSARY OF TERMS:** Attached at **Appendix A – Page 5**

**1. PURPOSE OF REPORT**

**1.1** To consider and determine this application for a variation to the premises licence for Select and Save, 9-11 Scalford Drive, Peterborough, PE1 4XQ taking into account the representations received from Cambridgeshire Constabulary, interested parties and a body (Welland Residents Association) representing interested parties.

**2. BACKGROUND INFORMATION**

**2.1** On 16 January 2006 an application for a new premises licence was submitted by Mr M Yousaf to allow the off sale of alcohol from 06.00 to 21.00. Representations were received from Cambridgeshire Constabulary as the premises were found to be selling alcohol on three occasions prior to obtaining a premises licence. (Despite the police informing the premises they were unable to sell alcohol during this time.) The application was determined by the licensing committee at a hearing which took place on the 13 March 2006. The committee's decision was to refuse the application.

**2.2** On the 20 March 2006 an application for a new premises licence was submitted by Mr N Yousaf to allow the off sale of alcohol from 06.00 to 21.00 Monday to Saturday and 07.00 to 20.00 on Sunday. No representations were received for this application and it was therefore granted on the 18 April 2006.

**2.3** On the 22 November 2006 a variation application was received to extend the sale of alcohol from 06.00 to 22.00 Monday to Sunday. As no representations were received to the variation application, the variation was granted on 22 December 2006.

2.4 A copy of the current plan and licence which shows the current authorisations, timings and conditions is attached at **Appendix B – Page 9**

### 3. SUMMARY OF VARIATION APPLIED FOR

3.1 To extend the hours for the sale of alcohol off the premises for an extra 6 hours per day Monday to Sunday. Current hours are 06.00 to 22.00, variation application is to extend hours to 06.00 to 04.00. The application does not include any extra conditions to be attached to the premises licence and states that *“it is not anticipated that the proposed variation poses any additional risk to the objectives and that the current working practices employed at the premises are sufficient.”*

### 4. APPLICATION

4.1 Please refer to the application and revised plan attached at **Appendix C – Page 19**

4.2 Representations have been received from Cambridgeshire Constabulary as a Responsible Authority under all of the objectives which are, the prevention of Crime and Disorder, the Prevention of Public Nuisance, public safety and the protection of children from harm. A copy of the representation is attached at **Appendix D – Page 41**

4.3 Representations have also been received from the three ward Councillors, namely Cllr Saltmarsh, Cllr Ash and Cllr Miners and Welland Residents Association. Copies of these representations are attached at **Appendix E – Page 43**

4.4 No representations have been received from any of the other Responsible Authorities i.e. Cambridgeshire Fire and Rescue Service, Peterborough City Council Planning Department, Peterborough City Council Health and Safety Team, Peterborough City Council Child Protection, Peterborough City Council Trading Standards and Peterborough City Council Environmental Pollution Team.

4.5 A copy of the ‘Notice’ that was advertised in the newspaper in accordance with Part 4 no. 25 of Statutory Instruments 2005 No. 42 – The Licensing Act 2003 (Premises licences and Club premises certificates) Regulations 2005 is attached at **Appendix F – Page 53**

4.6 The applicant has stated that no additional conditions have been identified from those already attached to the current premises licence.

### 5. RESPONSIBLE AUTHORITY

LICENSING OBJECTIVE:	REPRESENTATIVE:
Prevention of Crime and Disorder Public Nuisance Public safety Protection of children from harm	<b>Responsible Authority:</b> Cambridgeshire Constabulary One letter of representation from Cambridgeshire Constabulary  <b>To comply with the Data Protection Act all letters have been distributed to Committee Members and the applicant, but are not for public circulation</b>

#### 5.1 Summary of issues raised:

- Existing alcohol related antisocial behaviour in the locality
- The extra availability of alcohol in the locality is likely to exacerbate existing issues

## 6. INTERESTED PARTIES

LICENSING OBJECTIVE:	REPRESENTATIVE:	
<b>Prevention of Crime and Disorder</b>	<b>Interested Parties:</b> Representations from each of the three ward Councillors Cllr Saltmarsh, Cllr Ash and Cllr Miners	
<b>Public safety</b>		
<b>Prevention of Public Nuisance</b>		One letter from Welland Residents Association
<b>Protection of Children from harm</b>		<b>To comply with the Data Protection Act all letters have been distributed to Committee Members and the applicant, but are not for public circulation</b>

### 6.1 'Interested Parties' is defined as:

- A person living in the vicinity of the premises:
- A body representing persons living in that vicinity
- A person involved in the business in that vicinity: and
- A body representing persons involved in such a business
- A member of the relevant licensing authority

### 6.2 Summary of issues raised:

- Residents fear the increased hours will exacerbate the existing alcohol related anti social behaviour in the locality
- Residents fear for their personal safety due to persons congregating outside the shops
- Litter including cans and broken glass bottles
- Noise and nuisance from patrons utilising the shop during the proposed extended hours
- Anti social behaviour including, noise, shouting, swearing, spitting, urination and vomit
- Proximity to a Primary school and Children's (Sure Start) Centre
- Excessive hours for a residential area
- Area of social deprivation
- Street drinking already occurring potential to increase

## 7. MEDIATION

7.1 Mediation was attempted and the solicitor acting on behalf on the licence holder offered to reduce the hours for the sale of alcohol to 02.00. However this was not accepted by the interested parties and responsible authority making the representations. They felt that this was insufficient to alleviate the concerns raised. The solicitor has subsequently withdrawn this offer as it was not accepted.

## 8. LICENSING OFFICER'S COMMENT (FOR INFORMATION)

8.1 The changes to the plan have not been advertised in accordance with the regulations. The changes include a change to the existing layout and the inclusion of an external serving hatch. Members should also consider if the new plan can be accepted as part of this variation application.

8.2 In February 2007 the premises failed a test purchase, which resulted in a prosecution at the magistrates' court. The seller of the alcohol (Mr Sajid Yousaf) and the Designated Premises Supervisor (DPS) (Mr Naser Yousaf) both pleaded guilty to the sale of intoxicating liquor to a person under the age of 18. Further test purchases have been made at the premises and the premises refused the sale.

## **9. POLICY & GUIDANCE IMPLICATIONS**

**9.1** The following sections/paragraphs are applicable to this application:

### **9.2 Council's Statement of Licensing Policy**

- Objectives, section 4 on Page 8
- Fundamental Principles, section 6 on Page 9
- Licensing Hours, section 8 on Page 12
- Other Legislation, section 10 on Page 14
- Licence Conditions, section 13 on Page 16 and 17
- Delegation / Decision Making / Administration, Section 16 on page 18 and 19

### **9.3 Guidance Issued under Section 182 of the Licensing Act 2003**

- The Licensing Objectives, section 2 pages 16 to 25
- Determining applications, section 9 Pages 76 to 80
- Conditions attached to premises licences, section 10 pages 81 to 95
- Pools of conditions, Annex D page 131 to 147

## **10. LEGAL OFFICER'S COMMENTS**

**10.1** The Licensing Authority (hereafter referred to as 'the Council') is charged with implementing the provisions of the Licensing Act 2003. This is an application for the variation of a premises licence made under Section 34 of the Licensing Act.

**10.2** In this case, the application was received at these offices on 12 May 2010. The period during which relevant representations were made ended on 9 June 2010.

**10.3** The application before this committee will be treated on its own merits, and the Licensing committee will make its decision based upon:

- The merits of the application
- The promotion of the four licensing objectives
- The statement of policy of the Licensing Authority
- The Guidance issued by the Secretary of State for Culture, Media and Sport March 2010 under section 182 of the Licensing Act 2003.

**10.4** The licensing authority may determine the application, depending upon what is necessary for the promotion of the licensing objectives, in any of the following ways:

- decide to grant or vary the licence in the same terms as it was applied for
- decide to grant or vary the licence, but to modify or add conditions (to promote the licensing objectives);
- exclude from the scope of the licence a licensable activity
- decide to refuse to vary the licence

**10.5** Conditions are modified if they are altered, omitted or any new condition added (Section 35(4) Licensing Act 2003.

Note: In this document, the following definitions are included to provide an explanation of certain terms included in the Act. In some cases they are an abbreviation of what is stated in the Licensing Act 2003 or an interpretation of those terms. For a full definition of the terms used, the reader must refer to the Licensing Act 2003.

**‘Child’**

(a) means an individual aged under 16

(b) a child is unaccompanied if he is not in the company of an individual aged 18 years or over

**DCMS:** Department for Culture Media and Sport

**‘Designated Premises Supervisor’** means the person (who must be a Personal Licence Holder), in the case of premises selling alcohol, who will normally have been given the day to day responsibility for running the premises by the holder of the Premises Licence or will be the Premises Licence holder.

**‘Interested parties’:**

- a person living in the vicinity of the premises in question;
- a body representing persons living in that vicinity, e.g. a residents association;
- a person involved in a business in the vicinity of the premises in question;
- a body representing persons involved in such a business e.g. a trade association.
- a member of the relevant licensing authority e.g. a Councillor

**‘Late Night Refreshment’** means the supply of hot food or hot drink to members of the public (whether for consumption on or off the premises) between the hours of 11.00 pm and 5.00 am.

**‘Licensable Activities’** means: -

- The sale by retail of alcohol
- The supply of alcohol by or on behalf of a club to, or to the order of, a member of the club
- The provision of Regulated Entertainment
- The provision of Late Night Refreshment

**‘Licensing Authority’:** - is the licensing function of Peterborough City Council

**‘Licensed Premises’** includes club premises and events unless the context otherwise requires.

**‘Licensing Objectives’**

- The prevention of crime and disorder
- Public safety
- The prevention of public nuisance
- The protection of children from harm

**‘Operating Schedule’** means a document containing a statement of the following matters (and any others that may be prescribed): -

- The relevant Licensable Activities
- The times at which the Licensable Activities are to take place and any other times when premises are open to the public
- Information regarding the person who will be specified in the Premises Licence as the Premises Supervisor

- Where the Licensable Activities involve the supply of alcohol, whether it is for the supply on and/or off the premises
- The steps being taken to promote the Licensing Objectives

**'Rateable Value'**: as regards a premises, is the value for the time being in force for the premises entered in the local non-domestic rating list for the purposes of Part III of the Local Government Finance Act 1988(b).

**'Regulated Entertainment'** (Schedule 1 of the Act) means: -

- A performance of a play
- An exhibition of a film
- An indoor sporting event
- A boxing or wrestling entertainment
- A performance of live music
- Any playing of recorded music
- A performance of dance

Or entertainment of a similar description falling within the last three of the categories listed above, where the entertainment takes place in the presence of and for the purposes of entertaining that audience or spectators.

**Or** the provision of entertainment facilities:

Facilities for enabling persons to take part in entertainment of the following description for the purpose or purposes, which include the purpose of being entertained:

- making music
- dancing
- entertainment of a similar description

**'Relevant Licensing Authority'**: is the Authority in the area the premises are situated.

**'Responsible Authority'** means any of the following: -

- Cambridgeshire Constabulary (The Chief Officer of Police)
- Cambridgeshire Fire and Rescue (The Fire Authority)
- Health and Safety Team, Peterborough City Council
- Planning authority, Peterborough City Council
- Trading Standards, Peterborough City Council
- Environmental Health – Pollution, Peterborough City Council
- Children's Services – Child Protection & Review Manager
- Maritime & Coastguard Agency, Walton on Naze. (For vessels carrying more than 12 passengers.)
- Environment Agency, Peterborough (For vessels carrying 12 or less passengers).

**'Supply of alcohol'**:

- the sale by retail of alcohol, or
- the supply of alcohol by or on behalf of a club to, or to the order of, a member of the club.

**'Temporary Event Notice'** means a Permitted Temporary Activity involving one or more Licensable Activities subject to the following various conditions and limitations: -

- Duration – they are limited to events lasting for up to 96 hours;
- Scale – they cannot involve the presence of more than 499 people at any one time;



- Use of the same premises – the same premises cannot be used on more than 12 occasions in a calendar year, but are subject to the overall aggregate of 15 days irrespective of the number of occasions on which they have been used; and
- The number of notices given by an individual within a given period of time – a Personal Licence Holder is limited to 50 notices in one year, and another person to 5 notices in a similar period.

(In any other circumstances, a full Premises Licence or Club Premises Certificate will be required for the period of the event).

**‘the Act’:** means the Licensing Act 2003

**‘Vicinity’:** Given the normal everyday meaning of being ‘near to’ when considering the relevance of representations received from individual’s residence or business.

Licensing Act 2003\glossary of terms 13 March 2007

This page is intentionally left blank

**PART A****Premises Licence**

**Peterborough City Council, Environmental Services,  
 Bridge House, Town Bridge, Peterborough, PE1 1HU**

**Premises Licence Number**

049057

**Part 1 - Premises Details****Postal address of premises, or if none, ordnance survey map reference or description**

Select And Save  
 9-11 Scaford Drive

**Post Town** Peterborough**Post Code** PE1 4XQ**Telephone Number** 01733 345852**Where the licence is time limited the dates**

Start Date N/A  
 End Date N/A

**Licensable activities authorised by the licence****Sale by retail of alcohol**

The supply of alcohol will be for consumption off the premises

**The times the licence authorises the carrying out of licensable activities****Sale by Retail of Alcohol**

Monday to Sunday Between 06.00hrs and 22.00hrs

**The opening hours of the premises**

Monday to Sunday Between 06.00hrs and 22.00hrs

**Where the licence authorises supplies of alcohol whether these are on and / or off supplies**

The supply of alcohol will be for consumption off the premises

**Part 2**

**Name, (registered) address, telephone number and email (where relevant) of holder of premises licence**

Mr Naser Yousaf

**Registered number of holder, for example company number, charity number (where applicable)**

N/A

**Name, address and telephone number of designated premises supervisor where the premises licence authorises the supply of alcohol**

Mr Naser Amin Yousaf

**Personal licence number and issuing authority of personal licence held by designated premises supervisor where the premises licence authorises for the supply of alcohol**

Licence Number	047355
Issuing Authority	Peterborough City Council

## **Annex 1 - Mandatory conditions**

Licensees should note that the under enclosed Mandatory conditions should be read in conjunction with the granted licence and these conditions shall be enforceable where relevant to the operation of the premise and its activities.

### **Supply of alcohol (Premises Licence)**

This registration authorises the supply of alcohol subject to the following conditions:

1. No supply of alcohol may be made at a time when
  - (a) there is no designated premises supervisor in respect of the premises licence, or
  - (b) when the designated premises supervisor does not hold a personal licence or his personal licence is suspended.
  
2. Every supply of alcohol under the premises licence must be made or authorised by a person who holds a personal licence.

## **Annex 2 - Conditions consistent with the Operating Schedule**

### **Crime and Disorder**

3. Video/CCTV equipment will be set to record from the time that the premises open to the public until the premises close and all members of the public have left.
4. Notices advising that CCTV has been installed on the premises shall be posted up so that they are clearly visible to the public within the licensed premises.
5. Video/CCTV images shall be retained for at least one month and shall be produced to an authorised officer on demand.

### **Public Safety**

6. The licence holder must ensure that the premises complies with all existing relevant Health and Safety Regulations.

### **Public Nuisance**

7. A proof of age policy agreed by the police and local authority shall be implemented.

### **Protection of Children from Harm**

8. Any person selling or supplying alcoholic drink under the authority of a personal licence holder must ask for a photo ID proof of age where they have reason to suspect that the individual may be under 18 years of age.

**Annex 3 - Conditions attached after a hearing by the licensing authority - NONE**

**Annex 4 – Plans**



**PART B**

**Premises licence summary**

**Peterborough City Council, Licensing Section,  
Bridge House, Town Bridge, Peterborough, PE1 1HU**

**Premises Licence Number**

049057

**Premises Details**

**Postal address of premises, or if none, ordnance survey map reference or description**

Select And Save  
9-11 Scaford Drive

**Post Town** Peterborough

**Post Code** PE1 4XQ

**Telephone Number** 01733 345852

**Where the licence is time limited the dates**

Start Date N/A  
End Date N/A

**Licensable activities authorised by the licence**

**Sale by retail of alcohol**

The supply of alcohol will be for consumption off the premises

**The times the licence authorises the carrying out of licensable activities**

**Sale by Retail of Alcohol**

Monday to Sunday Between 06.00hrs and 22.00hrs

**The opening hours of the premises**

Monday to Sunday Between 06.00hrs and 22.00hrs

**Where the licence authorises supplies of alcohol whether these are on and/ or off supplies**

The supply of alcohol will be for consumption off the premises

**Name, (registered) address of holder of premises licence**

Mr Naser Yousaf

**Registered number of holder, for example company number, charity number (where applicable)**

N/A

**Name of designated premises supervisor where the premises licence authorises for the supply of alcohol**

Mr Naser Amin Yousaf

**State whether access to the premises by children is restricted or prohibited**

Restricted

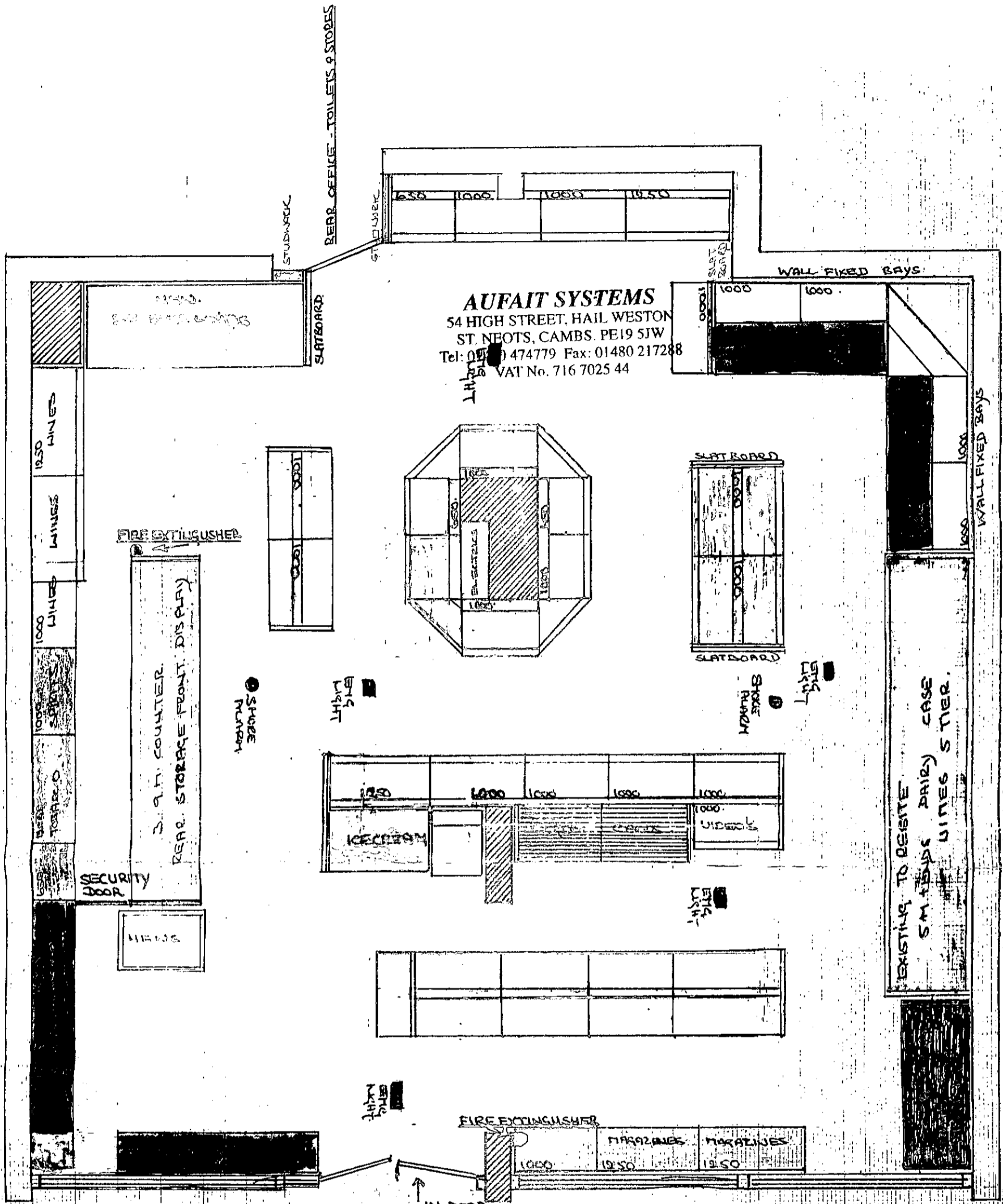

**AUFAIT SYSTEMS**  
 54 HIGH STREET, HAIL WESTON  
 ST. NEOTS, CAMBS. PE19 5JW  
 Tel: 01480 474779 Fax: 01480 217288  
 VAT No. 716 7025 44

CARD UNIT 1800mm High

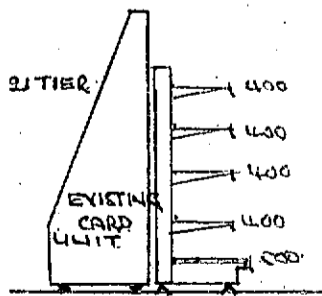

SHOP PLAN LAY OUT FOR  
 9-11 SCALFORD DRIVE, WELAND,  
 PETERBOROUGH PE1 4XQ  
 TEL No 01733-345852  
 DRAWING BY JOHN K HARRISON  
 DATE: 25-2-08  
 SCALE: 1:50

AUFAIT SYSTEMS  
 HIGH STREET, HAIL WESTON,  
 ST NEOTS, CAMBS PE19 5JW

**AUFAIT SYSTEMS**  
 GLENROY HOUSE  
 54 HIGH ST. HAIL WESTON  
 ST. NEOTS, CAMBS. PE19 5JW  
 TEL: 01480 474779  
 aufaitsystems@btinternet.com  
 VAT No: 716 7025 44

**AUFAIT SYSTEMS**  
 54 HIGH STREET, HAIL WESTON  
 ST. NEOTS, CAMBS. PE19 5JW  
 Tel: 01480 474779 Fax: 01480 217288  
 VAT No. 716 7025 44

This page is intentionally left blank

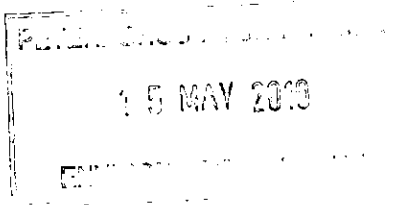

L4

Application to vary a premises licence under the Licensing Act 2003

Peterborough City Council, Licensing Section, Bridge House, Town Bridge, Peterborough, PE1 1HU

PLEASE READ THE FOLLOWING INSTRUCTIONS FIRST

Before completing this form please read the guidance notes at the end of the form. If you are completing this form by hand please write legibly in block capitals. In all cases ensure that your answers are inside the boxes and written in black ink. Use additional sheets if necessary. You may wish to keep a copy of the completed form for you records.

I/we NASER YOUSAF....., (Insert name(s) of applicant) being the premises licence holder, apply to vary a premises licence under section 34 of the Licensing Act 2003 for the premises described in Part 1 below

Premises licence number

04 90 57

Part 1 - Premises Details

Postal address of premises or, if none, ordinance survey map reference, or description SELECT AND SAVE 9-11 SCALFORD DRIVE	
Post town PETERBOROUGH	Post code PE1 4XQ

Telephone number at premises (if any)

01733 345 852

Non-domestic rateable value of premises

£ 10 600

**Part 2 – Applicant Details** (Please tick ✓)

Daytime Contact telephone number 01733 345 852

Email address (optional)

Current address if different from premises address

Post town PETERBOROUGH Post code

**Part 3 - Variation**

Please tick Yes

Do you want the proposed variation to have effect as soon as possible?

If not do you want the variation to take effect from

Day Month Year

--	--	--

If your proposed variation would mean that 5,000 or more people are expected to attend the premises at any one time, please state the number expected to attend

Please describe briefly the nature of the proposed variation (please see guidance note 1)

TO EXTEND THE PERMITTED HOURS FOR THE SALE OF ALCOHOL TO 04:00.

## Part 4 Operating Schedule

Please complete those parts of the Operating Schedule below which would be subject to change if this application to vary is successful.

### Provision of regulated entertainment

Please tick ✓/Yes

- a) plays (if ticking yes, fill in box A)
- b) films (if ticking yes, fill in box B)
- c) indoor sporting events (if ticking yes, fill in box C)
- d) boxing or wrestling entertainment (if ticking yes, fill in box D)
- e) live music (if ticking yes, fill in box E)
- f) recorded music (if ticking yes, fill in box F)
- g) performances of dance (if ticking yes, fill in box G)
- h) anything of a similar description to that falling within (e), (f) or (g)  
(if ticking yes, fill in box H)

### Provision of entertainment facilities for:

- i) making music (if ticking yes, fill in box I)
- j) dancing (if ticking yes, fill in box J)
- k) entertainment of a similar description to that falling within (i) or (j)  
(if ticking yes, fill in box K)

### Provision of late night refreshment (if ticking yes, fill in box L)

### Sale by retail of alcohol (if ticking yes, fill in box M)

**In all cases complete boxes N, O and P**

# A

<b>Plays</b> Standard days and timings (please read guidance note 6)			<b>Will the performance of a play take place indoors or outdoors or both – please tick [Y] (please read guidance note 2)</b>	
Day	Start	Finish	Indoors	
			Outdoors	
			Both	
Mon			<b>Please give further details here</b> (please read guidance note 3)	
Tue				
Wed			<b>State any seasonal variations for performing plays</b> (please read guidance note 4)	
Thur				
Fri			<b>Non standard timings. Where you intend to use the premises for the performance of plays at different times to those listed in the column on the left, please list</b> (please read guidance note 5)	
Sat				
Sun				



# B

<b>Films</b> Standard days and timings (please read guidance note 6)			<b><u>Will the exhibition of films take place indoors or outdoors or both – please tick [Y]</u></b> (please read guidance note 2)			
Day	Start	Finish	Indoors			
			Outdoors			
			Both			
Mon			<b><u>Please give further details here</u></b> (please read guidance note 3)			
Tue						
Wed					<b><u>State any seasonal variations for the exhibition of films</u></b> (please read guidance note 4)	
Thur						
Fri			<b><u>Non standard timings. Where you intend to use the premises for the exhibition of films at different times to those listed in the column on the left, please list</u></b> (please read guidance note 5)			
Sat						
Sun						

**C**

<b>Indoor sporting events</b> Standard days and timings (please read guidance note 6)			<b><u>Please give further details</u></b> (please read guidance note 3)	
Day	Start	Finish		
Mon			<b><u>State any seasonal variations for indoor sporting events</u></b> (please read guidance note 4)	
Tue				
Wed				
Thur				<b><u>Non standard timings. Where you intend to use the premises for indoor sporting events at different times to those listed in the column on the left, please list</u></b> (please read guidance note 5)
Fri				
Sat				
Sun				

**D**

<b>Boxing or wrestling entertainments</b> Standard days and timings (please read guidance note 6)			<u>Will the boxing or wrestling entertainment take place indoors or outdoors or both – please tick <input type="checkbox"/> (please read guidance note 2)</u>	Indoors	
Day	Start	Finish		Outdoors	
Mon			<b><u>Please give further details here</u></b> (please read guidance note 3)	Both	
Tue					
Wed			<b><u>State any seasonal variations for boxing or wrestling entertainment</u></b> (please read guidance note 4)		
Thur					
Fri			<b><u>Non standard timings. Where you intend to use the premises for boxing or wrestling entertainment at different times to those listed in the column on the left, please list</u></b> (please read guidance note 5)		
Sat					
Sun					

# E

<b>Live music</b> Standard days and timings (please read guidance note 6)			<b>Will the performance of live music take place indoors or outdoors or both – please tick [Y]</b> (please read guidance note 2)		Indoors	
					Outdoors	
Day	Start	Finish			Both	
Mon			<b>Please give further details here</b> (please read guidance note 3)			
Tue						
Wed			<b>State any seasonal variations for the performance of live music</b> (please read guidance note 4)			
Thur						
Fri			<b>Non standard timings. Where you intend to use the premises for the performance of live music at different times to those listed in the column on the left, please list</b> (please read guidance note 5)			
Sat						
Sun						

**F**

<b>Recorded music</b> Standard days and timings (please read guidance note 6)			<b><u>Will the playing of recorded music take place indoors or outdoors or both – please tick [Y]</u></b> (please read guidance note 2)	Indoors		
Day	Start	Finish		Outdoors		
Mon			<b><u>Please give further details here</u></b> (please read guidance note 3)	Both		
Tue						
Wed				<b><u>State any seasonal variations for playing recorded music</u></b> (please read guidance note 4)		
Thur						
Fri			<b><u>Non standard timings. Where you intend to use the premises for the playing of recorded music entertainment at different times to those listed in the column on the left, please list</u></b> (please read guidance note 5)			
Sat						
Sun						

# G

<b>Performances of dance</b> Standard days and timings (please read guidance note 6)			<u>Will the performance of dance take place indoors or outdoors or both – please tick [Y] (please read guidance note 2)</u>			
			Indoors			
Day	Start	Finish	Outdoors			
			Both			
Mon			<u>Please give further details here (please read guidance note 3)</u>			
Tue						
Wed					<u>State any seasonal variations for the performance of dance (please read guidance note 4)</u>	
Thur						
Fri			<u>Non standard timings. Where you intend to use the premises for the performance of dance entertainment at different times to those listed in the column on the left, please list (please read guidance note 5)</u>			
Sat						
Sun						

# H

<b>Anything of a similar description to that falling within (e), (f) or (g)</b> Standard days and timings (please read guidance note 6)			<b><u>Please give a description of the type of entertainment you will be providing</u></b>	
Day	Start	Finish	<b><u>Will this entertainment take place indoors or outdoors or both – please tick [Y] (please read guidance note 2)</u></b>	Indoors
Mon				Outdoors
				Both
Tue			<b><u>Please give further details here (please read guidance note 3)</u></b>	
Wed				
Thur			<b><u>State any seasonal variations for entertainment of a similar description to that falling within (e), (f) or (g) (please read guidance note 4)</u></b>	
Fri				
Sat			<b><u>Non standard timings. Where you intend to use the premises for the entertainment of similar description to that falling within (e), (f) or (g) at different times to those listed in the column on the left, please list (please read guidance note 5)</u></b>	
Sun				

<b>Provision of facilities for making music</b> Standard days and timings (please read guidance note 6)			<u>Please give a description of the facilities for making music you will be providing</u>		
			<u>Will the facilities for making music be indoors or outdoors or both – please tick [Y] (please read guidance note 2)</u>		Indoors
				Outdoors	
				Both	
<b>Day</b>	<b>Start</b>	<b>Finish</b>	<u>Please give further details here (please read guidance note 3)</u>		
Mon					
			<u>Please give further details here (please read guidance note 3)</u>		
Tue					
			<u>State any seasonal variations for the provision of facilities for making music (please read guidance note 4)</u>		
Wed					
			<u>State any seasonal variations for the provision of facilities for making music (please read guidance note 4)</u>		
Thur					
			<u>Non standard timings. Where you intend to use the premises for provision of facilities for making music entertainment at different times to those listed in the column on the left, please list (please read guidance note 5)</u>		
Fri					
			<u>Non standard timings. Where you intend to use the premises for provision of facilities for making music entertainment at different times to those listed in the column on the left, please list (please read guidance note 5)</u>		
Sat					
			<u>Non standard timings. Where you intend to use the premises for provision of facilities for making music entertainment at different times to those listed in the column on the left, please list (please read guidance note 5)</u>		
Sun					



# J

<b>Provision of facilities for dancing</b> Standard days and timings (please read guidance note 6)			<b>Will the facilities for dancing be indoors or outdoors or both – please tick [Y] (see guidance note 2)</b>	
			Indoors	
			Outdoors	
			Both	
Day	Start	Finish		
Mon			<b><u>Please give a description of the facilities for dancing you will be providing</u></b>	
Tue			<b><u>Please give further details here</u></b> (please read guidance note 3)	
Wed			<b><u>State any seasonal variations for providing dancing facilities</u></b> (please read guidance note 4)	
Thur				
Fri			<b><u>Non standard timings. Where you intend to use the premises for the provision of facilities for dancing entertainment at different times to those listed in the column on the left, please list</u></b> (please read guidance note 5)	
Sat				
Sun				

# K

<b>Provision of facilities for entertainment of a similar description to that falling within I or J</b> Standard days and timings (please read guidance note 6)			<b><u>Please give a description of the type of entertainment facility you will be providing</u></b>		
Day	Start	Finish	<b><u>Will the entertainment facility be indoors or outdoors or both – please tick [Y]</u></b> (please read guidance note 2)	Indoor	
Mon				Outdoor	
				Both	
Tue			<b><u>Please give further details here</u></b> (please read guidance note 3)		
Wed					
Thur			<b><u>State any seasonal variations for the provision of facilities for entertainment of a similar description to that falling within I or J</u></b> (please read guidance note 4)		
Fri					
Sat			<b><u>Non standard timings. Where you intend to use the premises for the provision of facilities for entertainment of a similar description to that falling within I or J at different times to those listed in the column on the left, please list</u></b> (please read guidance note 5)		
Sun					

**L**

<b>Late night refreshment</b> Standard days and timings (please read guidance note 6)			<b>Will the provision of late night refreshment take place indoors or outdoors or both – please tick [Y]</b> (please read guidance note 2)		Indoors	
					Outdoors	
Day	Start	Finish	<b>Please give further details here</b> (please read guidance note 3)			
Mon						
Tue						
Wed			<b>State any seasonal variations for the provision of late night refreshment</b> (please read guidance note 4)			
Thur						
Fri			<b>Non standard timings. Where you intend to use the premises for the provision of late night refreshment at different times, to those listed in the column on the left, please list</b> (please read guidance note 5)			
Sat						
Sun						

# M

Supply of alcohol Standard days and timings (please read guidance note 6)			Will the sale of alcohol be for consumption (Please tick box Y) (please read guidance note 7)	On the premises	
				Off the premises	<input checked="" type="checkbox"/>
Day	Start	Finish		Both	
Mon	06:00	07:00	<b>State any seasonal variations for the supply of alcohol</b> (please read guidance note 4)		
Tue	06:00	07:00			
Wed	06:00	07:00			
Thur	06:00	07:00		<b>Non-standard timings. Where you intend to use the premises for the supply of alcohol at different times to those listed in the column on the left, please list</b> (please read guidance note 5)	
Fri	06:00	07:00			
Sat	06:00	07:00			
Sun	06:00	07:00			

# N

Please highlight any adult entertainment or services, activities, other entertainment or matters ancillary to the use of the premises that may give rise to concern in respect of children (please read guidance note 8)

NONE

# O

Hours premises are open to the public Standard days and timings (please read guidance note 6)			State any seasonal variations (please read guidance note 4)
Day	Start	Finish	
Mon	06:00	04:00	
Tue	06:00	04:00	
Wed	06:00	04:00	
Thur	06:00	04:00	
Fri	06:00	04:00	
Sat	06:00	04:00	
Sun	06:00	04:00	

**Non standard timings. Where you intend to use the premises to be open to the public at different times from those listed in the column on the left, please list** (please read guidance note 5)

Please identify those conditions currently imposed on the licence which you believe could be removed as a consequence of the proposed variation you are seeking

NONE

Please Tick ✓ Yes

I have enclosed the premises licence

I have enclosed the relevant part of the premises licence

If you have not ticked one of these boxes please fill in reasons for not including the licence, or part of it, below

Reasons why I have failed to enclose the premises licence or relevant part of premises licence

## P

Describe any additional steps you intend to take to promote the four licensing objectives as a result of the proposed variation

a) General – all four licensing objectives (b,c,d,e) (see guidance note 9)

IT IS NOT ANTICIPATED THAT THE PROPOSED VARIATION REQUIRES ANY ADDITIONAL STEPS TO BE TAKEN TO PROMOTE THE LICENSING OBJECTIVES.

**b) The prevention of crime and disorder**

IT IS NOT ANTICIPATED THAT THE PROPOSED VARIATION POSES ANY ADDITIONAL RISK OF CRIME AND DISORDER AND THAT THE CURRENT WORKING PRACTICES EMPLOYED AT THE PREMISES ARE SUFFICIENT

**c) Public safety**

IT IS NOT ANTICIPATED THAT THE PROPOSED VARIATION POSES ANY ADDITIONAL RISK TO PUBLIC SAFETY AND THAT THE CURRENT WORKING PRACTICES EMPLOYED AT THE PREMISES ARE SUFFICIENT

**d) The prevention of public nuisance**

IT IS NOT ANTICIPATED THAT THE PROPOSED VARIATION POSES ANY ADDITIONAL RISK OF PUBLIC NUISANCE AND THAT THE CURRENT WORKING PRACTICES EMPLOYED AT THE PREMISES ARE SUFFICIENT.

**e) The protection of children from harm**

IT IS NOT ANTICIPATED THAT THE PROPOSED VARIATION POSES ANY ADDITIONAL RISK OF HARM TO CHILDREN AND THAT THE CURRENT WORKING PRACTICES EMPLOYED AT THE PREMISES ARE SUFFICIENT

Please tick ✓ Yes

- I have made or enclosed payment of the fee
- I have sent copies of this application and the plan to the responsible authorities and others where applicable
- I understand that I must now advertise my application
- I have enclosed the premises licence or relevant part of it or explanation
- I understand that if I do not comply with the above requirements my application will be rejected

**IT IS AN OFFENCE, LIABLE ON CONVICTION TO A FINE UP TO LEVEL 5 ON THE STANDARD SCALE, UNDER SECTION 158 OF THE LICENSING ACT 2003 TO MAKE A FALSE STATEMENT IN OR IN CONNECTION WITH THIS APPLICATION**

**Part 5 – Signatures** (please read guidance note 10)

Signature of applicant (the current premises licence holder) or applicant's solicitor or other duly authorised agent. (please read guidance note 11) If signing on behalf of the applicant please state in what capacity.

Signature ..... 

Date ..... 10/05/2010

Capacity ..... Solicitor

Where the premises licence is jointly held signature of 2<sup>nd</sup> applicant (the current premises licence holder) or 2<sup>nd</sup> applicant's solicitor or other authorised agent. (please read guidance note 12) If signing on behalf of the applicant please state in what capacity.

Signature .....

Date.....

Capacity .....

Contact name (where not previously given) and address for correspondence associated with this application (please read guidance note 13)	
Mr. Majid Sarnar H+V Solicitors 583 LINCOLN ROAD	
Post town	Post code
PETERBOROUGH	PE1 2PB
Telephone number (if any) 01733 743 743	
If you would prefer us to correspond with you by e-mail your e-mail address (optional) majid@hv solicitors.co.uk.	

*Peterborough City Council is registered under the Data Protection Act 1998 for the purpose of processing personal data in the performance of its legitimate business. Any information held by the council will be processed in compliance with the eight principles of the Act. Further information relating to your rights under the Data Protection Act can be sent to you on request.*





This page is intentionally left blank

**EMAIL FROM PC IFOR MADDOX**

On behalf of the Chief Constable, I would like to object to the 4am closing of the Select and Save application.

We have considered the application and are concerned that opening until 4am will impact on the 4 licensing objectives:

- the prevention of crime and disorder
- public safety
- the prevention of public nuisance
- the protection of children from harm

Antisocial behaviour has been a neighbourhood policing priority since April 09 to the present time. Alcohol related crime is already showing a 6.3% increase on last year and ASB an increase of 34.1% in the East Team Norths policing area.

Mapping where ASB is in the neighbourhood a high proportion are in the area surrounding Salford drive. Having a 4am closing time will in our opinion exacerbate the ASB and alcohol related ASB in the area.

A recent article in the ET had quotes from people living in the area they said the following:

**Person 1**

“I don’t think it is a good idea. I have a young baby and the shouting and noise might wake her up. I sometimes use the shop, but I don’t like the proposed new hours.”

**Person 2**

“There is supposed to be a law against people drinking in the street but that still happens and this will only make things worse. There is not a lot of trouble around here at the moment, but I am concerned it might start. We don’t want people fighting in the street.”

**Person 3**

“There is enough drink about as it is. There are problems with rubbish with cans and bottles being left in the street as well.”

**Person 4**

“I don’t see why there would be a need for the extra hours. There are enough places to get alcohol as it is.”

**Person 5**

“I can’t see that having that sort of kind of thing would be good in a residential area. “It’s going to create a lot of problems in an area where a lot of people are living. It might be different if it was in the city centre.”

The parade of shops in Central avenue were experiencing high ASB and a wide range of police measures culminating in a dispersal order were put in place.

We have also received a comment from the local PCSO who states:

"As the local officer I have witnessed a lot of unreported ASB around the licensed supermarket. There are a lot of people who hang around outside the supermarket drinking alcohol and are intimidating to members of the public. A lot of the time the people hanging around are quite intoxicated and loud. It is my belief by granting an extension to the liquor license will only have a detrimental effect on this residential area and bearing in mind the supermarket is opposite a school and a Sure Start building where Families are constantly coming and going. This area has historically has had a number of issues surrounding ASB, I do believe that if the license was granted until 4am this would attract and cause ASB in the local area.

**Ifor Maddox PC 292**  
**Northern Licensing Officer**

**Email from Councillor Saltmarsh – Ward Councillor**

I would also like to object to this application.

1 The extra opening hours will lead to more crimes being committed in the area. The police are very worried about this.

2 People gathering outside the shops with cans, bottles etc in their hands are very frightening to other users of the shops along the parade.

3 The extra noise at night will be a nuisance to local residents especially to those living in the flats above the shops.

4 Children will be put at risk as these premises are opposite a Primary school and a Children's Centre.

The Scalford Drive parade has only recently become a place where people feel safe and we do not want to go back to the days when it was a no go area.

Bella Saltmarsh  
Councillor for Dogsthorpe Ward

**THE LICENSING ACT 2003  
REPRESENTATION FORM FOR "INTERESTED PERSON" / "BODY"  
(living in the 'vicinity' of the premises detailed below)**

PETERBOROUGH CITY COUNCIL  
- 8 JUN 2010  
ENVIRONMENTAL HEALTH

Your name / Company name	Mr Chris Ash
(Name of Body you represent) Please tick one: <input checked="" type="checkbox"/> i) a person living in the vicinity of the premises <input type="checkbox"/> ii) a body representing persons who live in that vicinity <input checked="" type="checkbox"/> iii) a person involved in a business in the vicinity of the premises <input type="checkbox"/> iv) a body representing persons involved in these businesses <input type="checkbox"/>	
Postal Address (inc post code)	Members Services Town Hall Bridge Street
Contact telephone number:	756573 : or 452233
Mobile Number:	
Email address:	chris.ash@Peterborough.gov.uk.

Name of Premises you are making a representation about:	Select a Save
Address of the premises you are making a representation about:	9-11 Scafford Dr Peterborough PE1 4XQ

This section is about your representation/s. They must relate to one or more of the Licensing Objectives. Please detail the evidence supporting your representation, (under the relevant headings) and the reason for your representation/s. *It is important that you detail all matters that you wish to be considered. (Use additional sheets if necessary. Regulations provide that in considering representations the authority may take into account documentary or other information produced by the party either before the hearing or, with the consent of all parties, at the hearing.*

The prevention of crime and disorder Have not suited to area potential for disorder. - might for people to congregate	Public safety
The prevention of public nuisance Loss of amenity to local residents in area potential for noise nuisance	The protection of children from harm review of underage sales at store.
Suggested conditions that could be added to the licence to remedy your representations, or other suggestions you would like the licensing authority to take into account Licence <del>is</del> Have set to that which is appropriate for a residential area (9-11pm)	

The term 'vicinity' is used in the Licensing Act 2003, in particular with reference to those 'interested parties' (see definition in guidance attached) who may lodge objections to applications for premises licences and who may make representations concerning existing premises licences. Unfortunately the Act does not define the term 'vicinity' but the licensing authority will determine each case on its individual merit.

If the licensing authority considers that relevant representations are made the licensing team will consider arranging a mediation meeting between the relevant parties (if all agree) to try and reach a settlement. If this informal process is unsuccessful a hearing before the Licensing Sub Committee will follow, unless the interested parties withdraw their representations.

All representations in their entirety, including your name and address will be disclosed to the applicant for the premises licence.

Signed  Date 2-6-10  
.....  
Cllr. C. Ash  
.....  
Please print name

Please return this form along with any additional sheets to:

The Licensing Team  
Peterborough City Council  
Bridge House  
Town Bridge  
Peterborough  
PE1 1HU

Telephone: 01733 747474

Email: [eh.licensing@peterborough.gov.uk](mailto:eh.licensing@peterborough.gov.uk)

**This form must be returned within the Statutory Period, which is 28 days from the day after the day on which the application was given to the licensing authority by the Applicant.**

**However, because of the tight timescales involved, and to assist in the determination of the application process, any representations should be forwarded to the licensing authority AS SOON AS POSSIBLE and preferably within 14 days of notification of the application.**

**If in any doubt, please contact the Licensing Team on the above telephone number.**



## **Email from Councillor Miners – Ward Councillor**

Dear Teresa Martin,

Re: Licensing Act 2003 - Select and Save, 9-11 Scalford Drive, Welland, Dogsthorpe, Peterborough.

From the outset, may I say how astounded I was to learn of this application to sell alcohol 22hours a day from this retail outlet. The applicant has obviously no detailed knowledge of the surrounding community and its acute deprivation levels....or a sense of community responsibility.

From the outset, Welland has experienced a bad press. Some of it fabricated by an overzealous press - but some justified by its sheer historic levels of economic and social deprivation that generates a spiral of decline in family values.

In a 1989 report, P'Boro City Council financed the production of a document entitled 'Welland - A Project Appraisal'. Here was a comprehensive study listing some of the issues of local concern and identifying the urgent need for the Government and City to finance "Regeneration Projects" throughout the community area.

Various other in-depth studies followed - culminating in over £10m being spent on local environmental improvement schemes. Which is now only nearing final completion, thanks to investment by the new social landlord in the area, Cross Keys Homes.

The Greater Dogsthorpe Partnership (GDP) was financed & came into being solely on the back of certain high levels of social deprivation on Welland ("Hot Spots"). Without the recorded nationally recognised levels of poor health, unemployment, lack of work skills/training, secure family units, one-parent families, benefit dependency, severe income levels etc etc....the GDP would never have appeared locally.

Welland has always been blighted with a label of petty crime and social disorder. Adjoining communities stating that "them over there" are the culprits "those living there" are the ones responsible.

### **Crime & Disorder**

There is a record of anti-social behaviour in & around the shopping area where this shop is located. This culminated in various dispersal orders, installation of CCTV and increased local policing.

There is an alcohol problem in the area - an acute alcohol problem. There are large areas virtually swimming in discarded drink cans/bottles in the immediate vicinity. Local shrubbery seems to have more bottles/cans than flowering shrubs!



There is a problem already of drinkers sitting/camping outside the Children's Centre (Surestart) Acorn Centre opposite on the grassed frontage drinking their alcohol during daylight/work/school times (Welland Primary School is also opposite on the other side of the road). These drinkers seem to be waiting for friends or family members visiting the Children's Centre to come out!

Increased time & opportunity to buy even more alcohol at virtually all hours will lead to more acts of anti-social behaviour.

The lack of adequate and positive local community policing is already a local issue. How on earth are the Police going to cope with even more drink related social disorder & crime during these extended shop opening hours to sell cheap booze!

### **Public Safety**

The Police will hopefully be able to give more detailed historical information on the aspects of local public safety around this area.

Already many people feel intimidated by 'gatherings' of people obviously under the influence of drink or drugs.

Some families will not use this shop because they are in fear of their own personal safety. Will it be safe to walk home in the dark when there are individuals buying & drinking alcohol at all hours!

Alcohol attracts those elements in society that prey on easy targets and is the ignition required for acts of GBH and ABH.....culminating in violence and acts of theft etc.

Family units locally will suffer. Those addicted to drink will go and buy that extra can/bottle of booze - instead of that healthy food option for their baby/child. The temptation to buy and consume even more drink will be too much for those addicted. Resulting in more child abuse/partner abuse and drink related illnesses and deaths.

I know Alcoholics Anonymous is already very worried about the high levels of consumption of all ages locally and fearful of the damage young drinkers are doing to their physical and mental health.

### **Public Nuisance**

There is already a problem with discarded beer cans/bottles...wine/cider containers. Smashed glass is regularly crushed underfoot.

Coupled with the drink comes NOISE / SHOUTING / ARGUING / SWEARING / SPITTING / URINATING and sick being deposited everywhere.

Having lived locally in the area all my life and being a local councillor representing the area for over 30yrs - I am convinced such an extension to sell alcohol 22hrs a day will result in more acts of nuisance behaviour and fear of feeling safe to walk locally.

What about those living above the shop area. They will suffer acute public nuisance with cars driving to buy booze at all hours...no doubt with car radios/horns blaring and then speeding/racing along local roads.

**Protection of Children from harm**

Obviously I have touched on this issue in various previous statements above. Children will be in more danger of family abuse/attack.

They will be in danger of injury when walking/playing locally because of all the discarded bottles/cans/litter being strewn/thrown all over the place by people the worse for wear because of their lack of consumption control with alcohol levels.

Why is there a local Children's Centre in the community.....these Surestart centres are there to plug social gaps, to give/offer opportunities and attack poverty at its source.

If this application to sell alcohol locally 22hrs a day is allowed then this local authority is sourcing the continuing high levels of poverty and benefit dependency that so blights the local community.

We should be encouraging less alcohol consumption and not more. We have a social duty and responsibility to safeguard children and family well-being. There can be only one decision REFUSAL.

Kind Regards,  
Cllr Adrian Miners

## **Email from Councillor Miners Detailing Response from Local Resident**

Hi,

I have received a resident response to this application.

She wishes to remain anonymous but can be described as Mrs R.D.

I now repeat her exact words.

### *The Prevention of Crime & Disorder*

"It will increase both by encouraging people to have somewhere to congregate. It will give drunks and youths the chance to sit on the walls near the shops a drink at all hours & make an unruly row, when most residents just need to sleep. This often happens in the daytime now, but in the small hours of the morning the noise is exaggerated and will keep people awake. Cans & bottles are already thrown around everywhere now and children going to school in the morning do not need to have this type of rubbish to contend with. Why do people really need to shop at this time of the morning anyway!"

### *Public Safety*

"It will encourage even more drunks into the area and we have enough already in this socially deprived area."

### *The Prevention of Public Nuisance*

"This will cause an even bigger problem for people who live near the shop and many drunks already trot up & down Redmile Walk all day now. In the peace and quiet of the night the sound will become louder for residents. The shop needs to have less opening hours not more."

### *The Protection of Children from Harm*

"The shop is opposite a Primary School and also a Children's Centre. Obviously these are both closed at night, but the debris of cans & bottles is already visible in the day hours and is not nice for children and parents alike. Vomit can often be seen in the vicinity of the shop in the mornings & at the side of the shop, drunken men can be seen in the daytime urinating against the wall.

Parents are already witnessing anti-social behaviour and it is having the effect of making them feel that they do not want to park

their car near the shops or even come into the shop/s or attend groups at the Children's Centre.

Children attending the school are having to walk by drunks now and they should not have to be exposed to this"  
Unquote.



2 June 2010

Peterborough City Council,  
Licensing Section,  
Bridge House,  
Town Bridge,  
Peterborough  
PE1 1HU

Dear Sir/Madam,

I am writing about the proposed license application for the Select and Save shop, Scaford Drive, Welland, Dogsthorpe.

The Welland Residents Association held a meeting yesterday 1<sup>st</sup> June 2010, and it was generally agreed that the local residents are against this proposal, as we all feel that it would lead to more problems with excess litter and more trouble with drunken behaviour causing trouble in the local area.

The shop is located directly opposite Welland Primary School, and this is not setting a good example for children to see this kind of behaviour. The shop is located beneath flats, and located near local residents, there are lots of houses and flats nearby.

I hope that you can listen to the local residents views, and that you no do not grant them the extended license. The shop is already open from 8am til 10pm, and if people have not got their alcohol already by 10pm, then surely they can wait until 8am.

Sincerely,

A handwritten signature in black ink, appearing to read 'Wanda Robson'.

Miss Wanda Robson  
Secretary for Welland Residents Association

This page is intentionally left blank



# Classifieds

Need it, want it, buy it, sell it...

☎ telephone us now on...  
**01733 555222**  
✉ email us now on...  
**classifiedads@jpress.co.uk**

Public Notices

## Public Legal Take notice It could affect YOU!

Public Notices

**PETERBOROUGH CITY COUNCIL**

**Planning and Compulsory Purchase Act 2004**

**Notice of the Independent Examination of the Peterborough Core Strategy Development Plan Document by an Inspector Appointed by the Secretary of State for Communities and Local Government**

Notice is hereby given, in accordance with regulation 34 of the Town and Country Planning (Local Development) (England) Regulations 2004, of the arrangements for the independent examination of the Peterborough Core Strategy Development Plan Document.

The Secretary of State for Communities and Local Government has appointed Shelagh Bussey DipTP, DipEM, MA, PhD, MRTPI as the Inspector to conduct an examination to determine whether the above named document is sound.

A Pre-Hearing meeting will take place at 10.00 am on Wednesday 14th July 2010 at the Council Chamber, Town Hall, Bridge Street, Peterborough PE1 1HG to discuss the administrative arrangements for the examination.

The Hearing sessions for the examination will begin in the week commencing 27th September 2010 at the Town Hall, unless an alternative date and place are announced by the Inspector at the Pre-Hearing meeting. Precise details of the dates and places for the Hearing sessions can be obtained after the Pre-Hearing meeting from the Council's website [www.peterborough.gov.uk](http://www.peterborough.gov.uk) or from the Programme Officer for the examination, who is Steve Bateman BA, DipTP, DMS, IHBC, MRTPI. He can be contacted by telephone on 01733 452314 or via email to [programmeofficer@peterborough.gov.uk](mailto:programmeofficer@peterborough.gov.uk).

Head of Delivery Peterborough City Council  
28 May 2010



**The City of Peterborough (Maxey Road, Helpston) (Temporary Prohibition of Through Traffic) Order**

NOTICE is given that the Council of the City of Peterborough intends in not less than seven days to make an Order pursuant to section 14 of the Road Traffic Regulations Act 1984, the effect of which is to stop any vehicle from proceeding along the road known as Maxey Road, Helpston as lies between points 10 metres either side of the Maxey level Crossing railway level crossing.

The Council is satisfied that traffic should be prohibited due to works being proposed to be executed on the above road.

The alternative route for vehicles affected by this order is via Maxey Road, the B1443 (West Street and King Street), the C3 (King Street), the C4, Maxey Road and vice versa.

The proposed order will come into operation on the 05 June 2010 and will continue until the railway level crossing maintenance works have been completed or until the 04 December 2010, whichever is the earlier.

It is anticipated that the works will be completed between 21:30hrs Sat 05 June 10 until 08:00 sun 06 June 10.

A copy of the Order can be inspected at either: Town Hall, Bridge Street, Peterborough during normal office hours.

Destination Centre Peterborough & Central Library, Broadway, Peterborough during normal opening times.

Peter Tebb  
Traffic Manager  
Peterborough City Council  
Bridge House  
Town Bridge  
Peterborough  
PE1 1XG  
10/013  
27/05/10

Public Notices

The City of Peterborough  
(Various Roads Schedule 5)  
(Temporary Prohibition of Through Traffic)  
Order 2010

NOTICE is given that the Council of the City of Peterborough has made an Order pursuant to section 14 of the Road Traffic Regulation Act 1984, the effect of which is to stop any vehicle from proceeding along the roads as laid out in the Various Road Schedule 5.

The Council is satisfied that traffic should be prohibited due to works being proposed to be executed on the below roads.

The alternative routes for vehicles affected by this Order is laid out in the schedule below.

Location	Details	Start Date	End Date
Allan Ave Stanground	Road Closure (between hours of 0930 hours and sunset) Diversion route: Oakdale Ave, Wright Ave and visa versa	01/06/2010	08/06/2010
C40 Walcot Road Barnack	Road Closure (between hours of 0930 hours and sunset) Diversion route: C40 Walcot Rd Ufford; C2 Main St Ufford, C2 Bainton Rd Ufford, C2 Ufford Rd Bainton, B1443 Barnack Rd Bainton, B1443 Station Rd Barnack, B1443 Bainton Rd Barnack, C40 Stamford Rd Barnack and visa versa	01/06/2010	22/06/2010
C40 Stamford Road/Walcot Road Barnack	Road Closure (between hours of 0930 hours and sunset) Diversion route: C40 Walcot Rd Barnack, C40 Walcot Rd Ufford; C2 Main St Ufford, C2 Bainton Rd Ufford, C2 Ufford Rd Bainton, B1443 Barnack Rd Bainton, B1443 Station Rd Barnack, B1443 Bainton Rd Barnack, C40 Stamford Rd Barnack and visa versa	09/06/2010	16/06/2010
C41 Wittering Road Barnack	Road Closure (between hours of 0930 hours and sunset) Diversion Route: C41 Wittering Road, Barnack Drift, B1443 Stamford Road Barnack and visa versa	09/06/2010	16/06/2010
School Rd Barnack	Road Closure (between hours of 0930 hours and sunset) Diversion Route: Jack Haws Lane, B1443 Bainton Rd Barnack, C40 Stamford Rd Barnack and visa versa	09/06/2010	16/06/2010
B1443 Bukehorne Rd Thorney	Road Closure Diversion Route: Crowland Road (A1073); Thorney Road (A47), The Causeway (A47), Crowland Road (B1040) and visa versa	14/06/2010	05/07/2010
Storey's Bar Rd (between Vicarage Farm Rd and Padholme Road East)	Road Closure, between hours of 1900 and 0700 Diversion Route : Vicarage Farm Rd, Newark Rd and Padholme Rd and visa versa	28/06/2010	19/07/2010
A47 Thornhaugh junction, 800 metres either side of junction	Road Closure between hours of 1900 and 0700 Diversion route:A47 Old Leicester Rd, A1 north, A1 Tinwell off slip, A6121, A1 Tinwell on slip, A1 south, A1/A43 off slip, A43, A47 and visa versa	28/06/2010	12/07/2010

The Order will come into operation on the 01 June 2010 and will continue until the carriageway resurfacing works have been completed or until the 30 May 2011, whichever is the earlier. It is anticipated that the works will be completed on the 12 July 2010.

A copy of the Order can be inspected at the following locations:  
Town Hall, Bridge Street, Peterborough during normal office hours.  
Destination Centre, Bridge Street Peterborough or Central Library, Broadway, Peterborough during normal opening times.

For further information please contact John Rumbelow on 01733 453415.

Peter Tebb  
Traffic Manager  
Peterborough City Council  
Bridge House  
Town Bridge  
Peterborough  
PE1 1XG

10/012  
27/05/2010

**LICENSING ACT 2003**

**NOTICE OF APPLICATION FOR VARIATION OF PREMISES LICENCE.** Notice is given that I NASER YOUSAF have on the 12th May 2010 applied to Peterborough City Council as the Licensing Authority to vary the licence of the SELECT & SAVE of 9 - 11 SCALFORD DRIVE, WELLAND, PETERBOROUGH, PE1 4XQ by proposing to vary the premises licence to extend the permitted hours for the sale of alcohol to 4am, 7 days a week.

Anyone wishing to make representations concerning this application should do so in writing to:

**Peterborough City Council, Licensing Section, Bridge House, Town Bridge, Peterborough, PE1 1HU.**

Representations in respect of this application must reach the Licensing Authority by 9 JUNE 2010.

Persons wishing to inspect the register or the record of this application may do so by attending the office of the Licensing Section, during office hours, Monday to Friday inclusive.

It is an offence knowingly or recklessly to make a false statement in connection with an application, the maximum fine for which on summary conviction is £5000.

**IMPORTANT NOTICE TO OUR ADVERTISERS**

On placing an advertisement in this publication you will have agreed to accept our standard terms and conditions of advertising and payment. These are set out in full at <http://www1.investorrelations.co.uk/jppic/termsofaccess>.

If you wish to advertise with us, please download a copy and keep for your records. Alternatively, for a printed copy and/or for a copy of our current rate card please contact the Advertising Department on 01733-555111 or call in to 57 Priestgate, Peterborough, PE1 1JW. Our terms and conditions are applicable to all advertising booked or other business transacted. Please note that our terms and conditions may change from time to time and you should therefore obtain a fresh copy everytime you advertise with us.

Public Notices



**HIGHWAYS AGENCY**  
ROAD TRAFFIC REGULATION ACT 1984 - SECTION 14(1)(A)  
**THE A14(M) MOTORWAY (A1(M) MOTORWAY JUNCTION 14 TO THE A14 TRUNK ROAD, ALCONBURY, CAMBRIDGESHIRE) (TEMPORARY PROHIBITION OF TRAFFIC) ORDER 201**

NOTICE IS HEREBY GIVEN that the Secretary of State for Transport intends to make an Order on the A14(M) at Alconbury in Cambridgeshire to provide a safe working environment for the workforce whilst bridge inspection and surfacing work is carried out.

The works would take place over 2 nights (8pm to 6am) and are expected to begin on Tuesday 22 June 2010. The Order would come into force on 14 June 2010 and have a maximum duration of eighteen months.

The effect of the Order would be to close -

- on Tuesday 22 June 2010 the southbound -
  - carriageway of the A14(M) from its diverge from the A1(M) Motorway at Junction 14 to its merge with the A14 Trunk Road (south of the B1043 Rusts Lane, Alconbury), a distance of approximately 2569 metres, and
  - exit slip road of the A14(M) leading to the B1043 Rusts Lane, Alconbury,
 diverting vehicles via the A1(M) southbound and A1 to Brampton Hut Interchange, here to join the A14 eastbound to Spittals Interchange; and
- on Wednesday 23 June 2010 the northbound -
  - carriageway of the A14(M) from its junction with the exit slip road leading to the B1043 Rusts Lane, Alconbury to its merge with the A1(M) Motorway at Junction 14, a distance of approximately 2833 metres, and
  - entry slip road of the A14(M) leading from the B1043 Rusts Lane, Alconbury,
 diverting vehicles onto the B1043 northbound to join the A1(M) at Junction 15.

The closures, which would not apply to emergency service, traffic officer or works vehicles, and diversion routes would be clearly indicated by traffic signs for the duration of the works.

**MRS A V MIDDLETON**  
An official of the Highways Agency

General Enquiries relating to this notice may be made in writing to Steve Cox at the Highways Agency Woodlands, Manton Lane Industrial Estate, Manton Lane, Bedford MK41 7LW or by telephoning 01234 795255.

**The City of Peterborough (King Street Peterborough) (Temporary Prohibition of Through Traffic) Order 2010**

NOTICE is given that the Council of the City of Peterborough intends in not less than seven days to make an Order pursuant to section 14 of the Road Traffic Regulations Act 1984, the effect of which is to stop any vehicle from proceeding along the road known as King Street Peterborough for its entire length.

The Council is satisfied that traffic should be prohibited due to events being proposed to be executed on the above road.

There is no alternative route for vehicles affected by this order.

The proposed Order will come into operation on the 12 June 2010 and will continue until the England World Cup events have been completed or until the 11 June 2011, whichever is the earlier.

It is anticipated that the events will be carried out on various dates between the 12 June 2010 and the 12 July 2010. Times and dates are as follows:  
Commencing at 12:00hrs on the day until 02:00hrs on the next day, Saturday 12th, Friday 18th, Saturday 26th, Friday 2nd July, Tuesday 6th July and Saturday 10th July.

Also Commencing at 07:00hrs on the day until 02:00hrs on the next day, Sunday 27th June, Saturday 3rd July, Wednesday 7th July and Sunday 11th July.

A copy of the Order can be inspected at the following locations:

Town Hall, Bridge Street, Peterborough during normal office hours.

Destination Centre, Bridge Street Peterborough or Central Library, Broadway, Peterborough during normal opening times.

For further information please contact Simon Baker on 01733 688434.

Paul Hardy  
Head of Environment Transport and Engineering  
Peterborough City Council  
Bridge House  
Town Bridge, Peterborough, PE1 1XG  
10/014, 03/06/2010



Public & Legal Notices

**Why you should read these.**  
Public and Legal notices could effect you in many ways. These notices inform the public of planning act notices from roads to buildings as well as licensing act notices, insolvency acts, notices to creditors, missing beneficiaries etc.



This page is intentionally left blank



## Staff set for charity run

STAFF at a city recruitment firm are lacing up their running shoes to get in training for the Great Eastern Run.

Five workers at Brook Street Employment Agency, in Westgate, Peterborough, will run in the October 10 race in aid of city charity the Association for Spina Bifida and Hydrocephalus.

Michaela Chantrell, Amy Jayne Elvestad, Amy McKeogh, Gemma Goward and Laura Edwards will be tackling the 13.1 mile run.

The employment agency joins runners from Peterborough.Net and the city's Passport Office who are already on board to run for ASBAH.

Michaela Chantrell, branch manager, said: "We are really excited to be able to support ASBAH and feel privileged to take part in the run."

ASBAH is still looking for runners. The charity will pay the entry fee and supply a T-shirt or vest, sponsor forms and information on fundraising. Contact 01733 421328 or email ianm@asbah.org.



**READY TO RUN:** Brook Street Employment Agency staff (from left) Gemma Goward, Amy McKeogh, Amy Jayne Elvestad and Laura Edwards will tackle the Great Eastern Run for ASBAH. (METP-28-05-10BD300) Picture: BEN DAVIS

## Play season starts with Shakespeare

THE summer season of plays by the Stamford Shakespeare Company (SSC) is to get under way on Monday.

The highly-reputed theatre group will be putting on three plays throughout the summer in the beautiful surroundings of the grounds of Toletorpe Hall, in Little Casterton, near Stamford.

The two plays by the bard which will be performed this summer are Othello and the romantic tale, Much Ado About Nothing.

As is traditional for the SSC, they will also be putting on a non-Shakespeare performance in the form of Dad's Army, which will feature three classic episodes specially adapted for the stage.

The season runs until August 28. For show dates and tickets, call 01780 756133 or visit www.stamfordshakespeare.co.uk.

## Learn about justice at city event

PEOPLE can learn more about the criminal justice system at an event in the city on Saturday.

The Justice Journey event, at KingsGate Conference Centre in Staple Way, Parnwell, will run from 9.30am to 2pm.

Organised by the SaferPeterborough partnership, the event will offer information about how the partnership is focusing on anti-social behaviour and supporting victims, as well as letting people know about what happens to offenders when they enter the criminal justice system and what punishments are available to the courts.

Michelle Bernasconi, of the Victims Advisory Panel, will launch the event by detailing her personal experiences of being a victim of anti-social behaviour.

People will be able to ask questions of police officers, representatives of the Crown Prosecution Service, magistrates and officer from the probation service.

# Store launches 4am drinks bid

By **STEPHEN BRIGGS**

stephen.briggs@peterboroughtoday.co.uk

**PLANS** by a city shop to sell alcohol until 4am have been met with anger by residents living nearby.

The Select and Save shop, in Scaford Drive, Welland, has applied to Peterborough City Council for a licence to sell alcohol from 6am until 4am, seven days a week.

Currently, the shop – which is opposite Welland Primary School – has a licence to sell alcohol until 10pm.

A decision will be made on June 9 and if approved the shop could start trading with its new hours the following day.

However, people living nearby are concerned about noise, trouble and litter which could be created by the new hours.

Mother Ester Zawisza (29) said she was concerned that there would be more noise at night.

She said: "I don't think it is a good idea. I have a young baby and the shouting and noise might wake her up. I sometimes use the shop, but I don't like the proposed new hours."

Another resident, Wendy Clark (47), added: "There is supposed to be a law against people drinking in the street but that still happens and this will only make things worse."

"There is not a lot of trouble around here at the moment, but I am concerned it might start. We don't want people fighting in the street."

Teresa Pickett (43) added: "There is enough drink about as it is. There are problems with rubbish with cans and bottles being left in the street as well."

Her husband Christopher Pickett (50) added: "I don't see why there would be a need for the extra hours. There are enough places to get alcohol as it is."

Councillor Chris Ash, ward councillor for Dogsthorpe, said: "I can't see that having that sort of kind of thing would be good in a residential area. I will be putting in a formal comment to the council along those lines."

"It's going to create a lot of problems in



**PLANS:** The off-licence at Scaford Drive, Welland, which wants to sell alcohol until 4am. (METP-29-05-10AS009). Picture: ALAN STORER

an area where a lot of people are living. It might be different if it was in the city centre."

A Peterborough City Council spokeswoman said there are 16 premises in the city licensed to serve alcohol longer than the planned hours at the shop. Of those, six are pubs and clubs, including city centre bar Angels and The Cresset theatre at Bretton. The remaining 10 include supermarkets, large convenience stores and hotels.

Owner of Select and Save, Naser Yousaf, said the hours would help him compete with other stores.

He said: "Keeping the shop trading until 4am will ensure we serve the needs of the community. I am also taking this action because of competition from nearby supermarkets."

He said night staff would serve customers through a hatch to ensure security.

Cambridgeshire police community safety and licensing team leader Debbie Sampson said police are gathering information before making a representation to the city council on the application.

Anyone wishing to make representations should do so in writing to: Peterborough City Council, Licensing Section, Bridge House, Town Bridge, Peterborough PE1 1HU.

## NEWS BRIEFS

### Get arty for half term at city museum

CREATIVE families are being urged to unleash their hidden artistic talents at a series of half-term events.

Peterborough Museum and Art Gallery, in Priestgate, is hosting the sessions which take place daily from 10.30am to 12.30pm, followed by short talks at 12.30pm. The cost is £1 per child per morning session and for more information call (01733) 864663.

### Walk and raise funds for diabetes charity

DIABETES UK are hosting their annual Walk in the Park on June 27. The fundraising event takes place from 11am to 1pm at Central Park, Peterborough. To raise funds, register and receive your Walk Pack, including sponsorship forms, contact Glennis Bentley on 07516864125 or email glennis.bentley@talktalk.net or visit www.peterborough.diabetesukgroup.org.

### Motorbike is found torched after theft

POLICE are hunting a thief who stole a motorbike which was later found burned out.

The Honda motorbike was taken from Paynels, in Orton Goldhay, Peterborough, between 2.30am and 7.15am on May 27.

It was stolen from the rear garden of the property, which was secured by a locked gate.

Anyone with information should call police on 0345 456 456 4.

### Police to meet with local residents

RESIDENTS can meet their local police teams next week.

A neighbourhood surgery is being held on June 10 from 12.30pm to 1.30pm, at Napier Place, in Orton Wistow, Peterborough.

The event gives residents in Orton Wistow the chance to meet officers from the neighbourhood policing team and raise local issues.

10% OFF

WITH THIS ADVERT

Because WE CARE

ABOUT YOUR FOOTWEAR

SHOE REPAIRS & KEY CUTTING

Including Car Keys & Remote Programming  
Locks & Security Engraving plus Other Sundries

The Market Cobbler

City Market, Northminster Peterborough PE1 1AY

Telephone 01733 340540



## Telegraph Comment

### Late night drinks a cause for concern

PEOPLE'S social lives have changed so much in recent years and licensing laws have been updated to reflect that.

Family life and working shift patterns are so different to what they were a generation ago, people are coming and going at all hours of the day and night.

So it is not unusual to see nightshift workers in a pub at breakfast time, and evening workers unwinding in a bar well into the early hours.

Most people now take it for granted. But the fact that an off-licence in a busy residential street on the Welland estate wants to stay open to sell booze until 4am is alarming.

A city centre late bar is one thing, but does anyone want people wandering near their homes in the middle of the night in search of drink?

### A need for clarity on home building

THE setting of targets for house building in the city has been controversial.

This was highlighted only a few months ago, when residents of Eye made their feelings known about plans to build hundreds more homes in the village.

They point out that Eye has seen massive homes projects while other villages have remained untouched.

The review by the new government of guidelines on what can be built and where is merited.

The city needs development, some plans should go ahead, others need reviewing. It is vital that all our key agencies pull in the right direction for Peterborough.

## Telegraph Contacts

**The Evening Telegraph**  
57 Priestgate, Peterborough PE1 1JW  
Tel: 01733 555111 Fax: 01733 313147  
(editorial) 01733 555188 (advertising)  
E-mail: news@peterboroughtoday.co.uk or  
eteditor@peterboroughtoday.co.uk

- **Editor:** Mark Edwards
- **Deputy editor:** Nigel Thornton
- **Asst' editor (production):** Brad Barnes
- **News editor:** Paul Grinnell
- **Features editor:** Julia Ogden
- **Business editor:** John Kravich
- **Sports editor:** Bob French
- **Chief photographer:** Rowland Hobson
- **Entertainments reporter:** Mark Pearson
- **Reporters' direct line:** 01733 588720
- **Photographic direct line:** 01733 588740
- **Sport direct line:** 01733 588710
- **Classified ads:** 01733 555222
- **Home delivery 24-hr hotline:** 01604 467000

OUR policy is to take an objective view of local news while continuing to reflect the interests and concerns of the community we serve. We try to avoid errors, but sometimes mistakes slip through the net during the hectic process of producing a daily newspaper. We will correct these promptly and, where appropriate, publish a clarification or apology.

The Evening Telegraph adheres to the Press Complaints Commission's code of practice. If you have a complaint, write to The Editor, Evening Telegraph, 57 Priestgate, Peterborough, PE1 1JW. Alternatively, you may contact the PCC at Halton House, 20/23 Holborn, London EC1N 2JD



Recycled paper made up 87.2% of raw material for UK newspapers in 2008

# YOUR Telegraph

the evening

WRITE TO: Your Telegraph,  
The Evening Telegraph,  
57 Priestgate,  
Peterborough PE1 1JW

## Making a stand for town issues

I INTEND to stand for district and town councillor for the Kingsmoor ward of Whittlesey in the 2011 Local Elections under the Independent banner. I am standing as an Independent as I believe that local politics should be about what local people think and not what the parties think and that a councillor should not be drawn by a party line.

I am standing in a seat where one man has become a local political giant who currently holds the seat for this ward on Whittlesey Town and Fenland District Council and holds it as part of the Whittlesey North County Council seat, Councillor Martin Curtis.

My aims are simple, provide a large voice on Fenland District Council for the area I have lived in all my life and have such passion about. I aim to serve the people of this area to the best of my ability and in the run up to the election prove at least to be a strong challenge to Cllr Curtis.

Do not write me off for my inexperience as everyone needs to start somewhere but I believe that I should make my first move in an area I know well and I hope that I can gather a large following.

Further reasons for me standing for district and town council next year - Whittlesey is now growing at a greater pace than ever and the job of a district councillor is to represent their parish in such areas as council housing, planning, rubbish collection, the local environment, and the administration of elections. I am beginning to work towards a career in local/town planning and have great knowledge in these areas and have regularly campaigned for the improvements to local services as some of you may know. This ward in particular has a massive planning challenge over the next few years with plans for 460 (approx) new house to be built on Basenhally Farm and suggestions that a new supermarket may be built on the other side of the already strained main

## STAR LETTER

A605 road. I am an advocate of a Whittlesey Bypass and the building of the King's Dyke Flyover.

Many people have told me that a bypass may take business away from town centre shops but this is not the case. The shops are used by local people from Coates, Turves, Eastrea and Whittlesey and so would not be affected by a bypass and people who travel from outside the area to shop come to do that and would not use a new bypass. The main aim of a new bypass would be to give people an alternative route from March to Peterborough and to make sure that when the A47 is blocked that the A605 through Whittlesey is not used as a rat run.

People who say a King's Dyke flyover is not needed need to look at what happens when the crossing is closed for engineering works, there are three alternative routes; north bank which cannot cope with HGVs and is shut at various times throughout the year through flooding, travelling the back roads through Pondersbridge which adds 3-4 miles each way to your journey and has many treacherous bends and the A47 which adds 7 miles each way and travelling through Thorney depends on the B1040 Wash Road being open.

The council promised that after the Stanground Bypass has been built the King's Dyke Flyover would begin to be built which would cause havoc but would have massive benefits in the future as the amount of trains passing through on this line is to increase as more freight is being planned to be moved from Felixstowe to the midlands Via Peterborough by rail.

I hope this explains why I have chosen to stand to be district and town councillor for the Kingsmoor Ward in Whittlesey.

BERNARD RANDALL  
Whittlesey

## YOUR VIEW

"A double rainbow over the Queensgate centre taken on a Friday evening a couple of weeks ago. It was the most vivid rainbow I have even seen," says ET reader Vicky Richings.

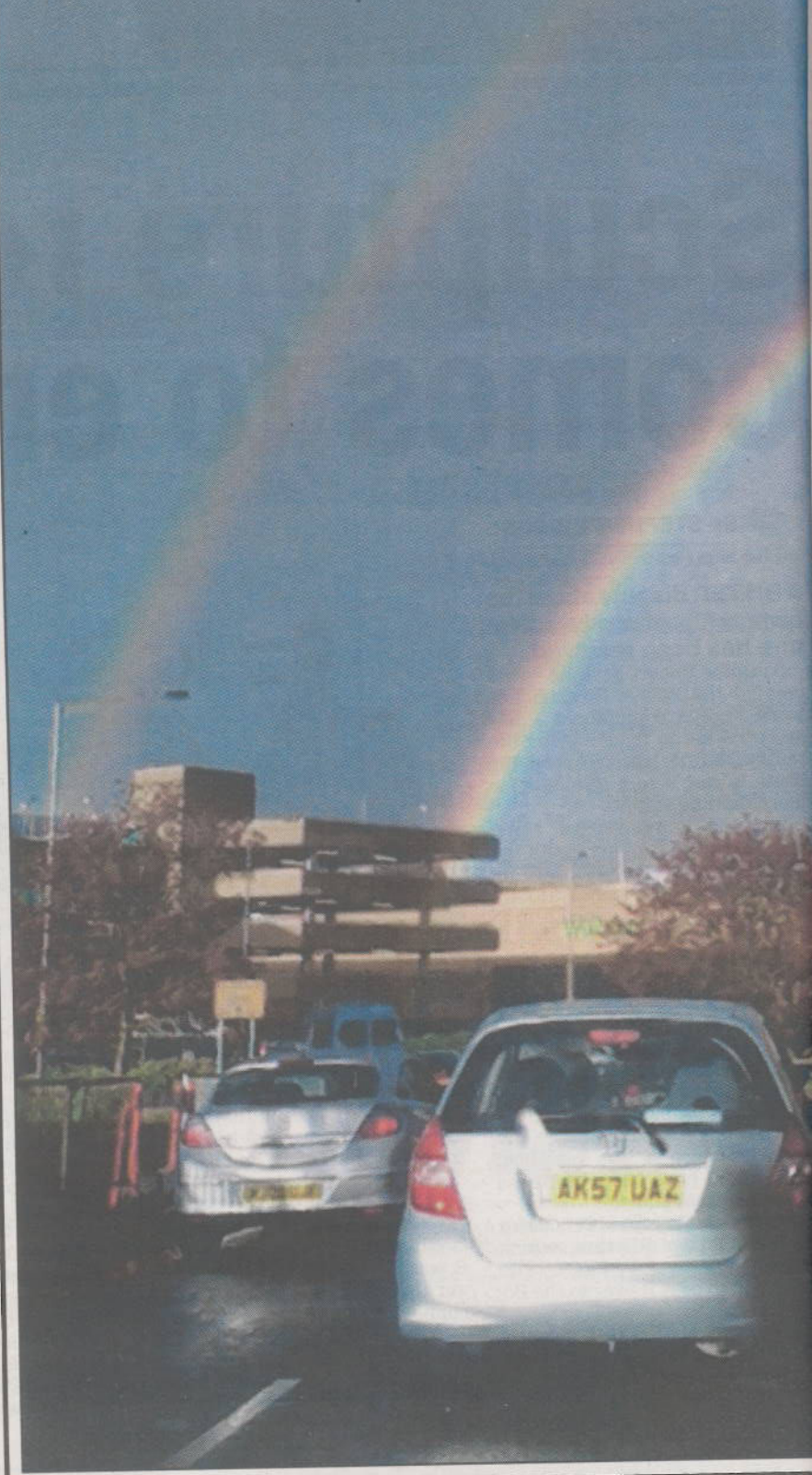

## STRAIGHT TALKING

St Guthlac's pupils in Crowland, near Peterborough, who became prisoners for a day learning about crime were asked what they had learned.



James Turnbull, (14), said: "I will be more cautious about what my friends are doing, I don't want a criminal record, it could affect my whole life."



Amber Reynolds (15) said: "We have been given good advice on how to stay out of trouble. I can see now why my parents worry about me sometimes."